

Fill Adapters

A0030 Tight Fill Adapter

The Emco Wheaton A0030 Adapter is designed for use with conventional dual point fill systems. Features recessed threads and a Buna-N gasket. Use with the A0097 Tight Fill Cap.



■ CARB E.O. G-70-97-A
ULC Listed MH27242

Model No.	Material	Thread Size	Cam & Groove	Weight	A	B
A0030-024	Brass	4" Female NPSM	4"	3.0 lbs.	4.9"	2.2"
A0030-024A	Aluminum	4" Female NPSM	4"	0.8 lbs.	4.9"	2.2"
A0030-024B	Brass	4" Female BSPP	4"	3.0 lbs.	4.9"	2.2"
A0030-024BA	Aluminum	4" Female BSPP	4"	0.8 lbs.	4.9"	2.2"
A0030-114	Aluminum	4" Female BSPP	4" MIL	1.5 lbs.	5.5"	4.0"

■ LFEPA Approval (A0030-114)

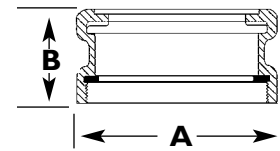

A0030-124S Tight Fill Swivel Adapter

The Emco Wheaton A0030-124S Adapter Swivel prevents accidental loosening of the adapter from the fill pipe. Buna-N gasket, Viton® o-rings. Use with the A0097 Tight Fill Cap. The A0030-124S is field serviceable with o-ring kit 494301. Use the Emco Wheaton A0081 Adapter Wrench for installation.



Model No.	Material	Thread Size	Cam & Groove	Weight
A0030-124S	Brass	4" Female NPSM	4"	7.8 lbs.

Viton® is a registered trademark of DuPont Dow Elastomers.

■ Approved under Phase I EVR
Executive Order VR-105-A

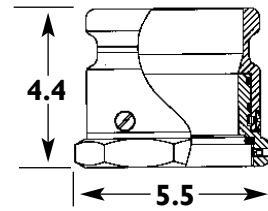

A0089, A0096 Coaxial Tight Fill Adapters

Emco Wheaton Coaxial Vapor Recovery Adapters are designed for standard coaxial fill systems and coaxial systems with self-sealing vapor lines. Features recessed threads for easy installation and positive seating on riser pipes. Use with the A0097 Tight Fill Cap.



Model No.	Used With	Material	Size	Weight
A0089-001	A0088	Aluminum	4" Female NPSC	3.1 lbs.
A0096-001	A0070	Aluminum	4" Female NPSC	3.1 lbs.

